

4611130001037

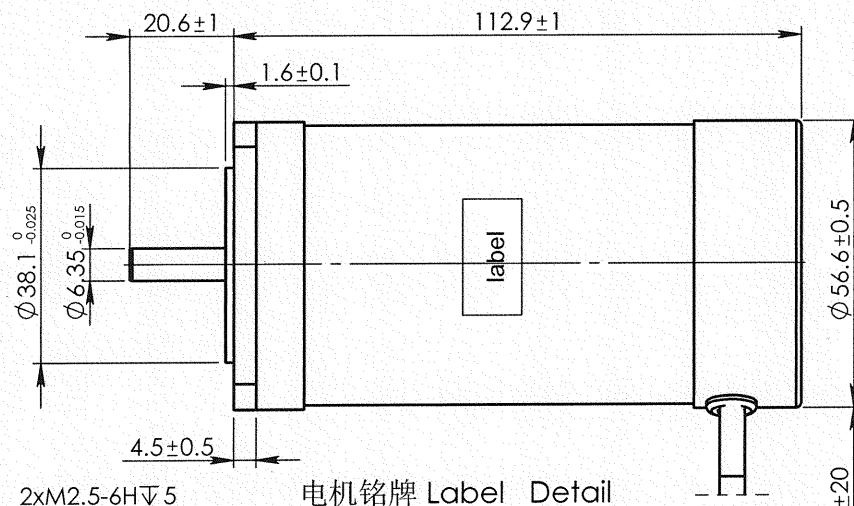
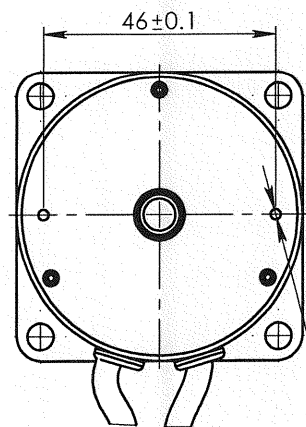
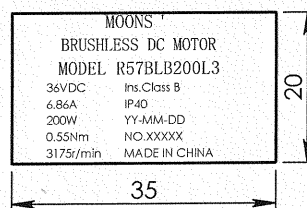
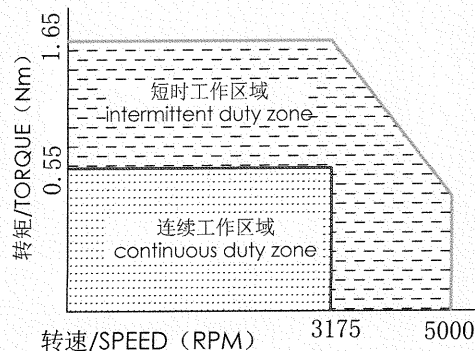
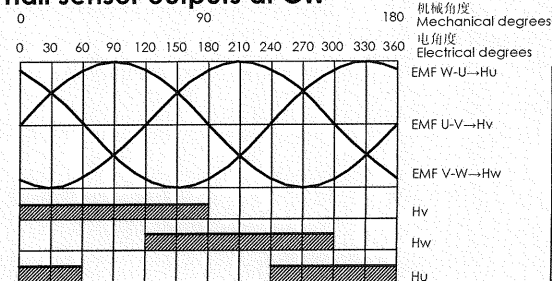
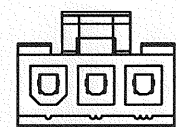

电机铭牌 Label Detail

转矩-转速特性
Torque-speed specifications线反电势与霍尔相位关系图 (顺时针)
Relation between phase EMF's and hall sensor outputs at CWP向
MOLEX
39-01-4031

编号 NO.	线色 COLOR	定义 FUNCTION
1	蓝/blue	W
2	橙/orange	U
3	黄/yellow	V

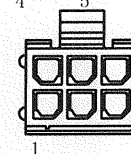
P向
MOLEX
43025-0600
BLU BLK ORN
4 5 6

编号 NO.	线色 COLOR	定义 FUNCTION
1	红/red	VCC(+5V)
3	黄/yellow	Hv
4	蓝/blue	Hw
5	黑/black	GND
6	橙/orange	Hu

规格
Specifications

1	额定电压/Rated power supply	36	VDC
2	额定输出功率/Rated output power	200	W
3	极数/poles	4	
4	相数/Phase	3	
5	额定转速/Rated rotational speed	3175	RPM
6	最大转速/Maximum speed	5000	RPM
7	额定转矩/Rated torque	0.55	Nm
8	额定电流/Rated winding current	6.86	A
9	线反电势系数/Voltage constant±10%	8.3	Vrms/krpm
10	惯量/Moment of inertia	2.34x10 ⁻⁵	kgm ²
11	线电阻Ph/ph resistance±0.1Ω at 20℃	0.49	Ω
12	线电感Ph/ph inductance±30% at 1KHz 20℃	1.19	mH
13	电机质量/Motor mass	1.2	kg
14	绝缘等级/Insulation class	B	130℃
15	防护等级/Protective enclosure rating	IP40	

Unit: mm

第一角画法
FIRST ANGLE METHOD未注线性与角度尺寸公差
Tolerances for linear and angular dimensions without
individual tolerance indications

GB/T 1804-m eqv ISO 2768-1 : m

未注形状与位置尺寸公差
Geometrical tolerance for features without
individual tolerance indications

GB/T 1184-K eqv ISO 2768-2 : K

批准 Approve

标准化 Standard

工艺 Technology

审核 Check

设计 Design

MOONS'

Shanghai Moons' Electric Co., Ltd.

This document is released for information only. Its reproduction in whole or in part or its dissemination to third parties is prohibited. All trademarks and registered trademarks appearing on this document are the property of their respective owners.

Type: R57BLB200L3

Rev.A

SCALE 1:1.5 Sheet 1 of 1